

# ARTS



## Bird House and Art Auction in Sonoma

**O**ne-of-a-kind birdhouses and unique artwork designed by Sonoma community artists will be auctioned at the Sonoma Community Center's second Birdhouse and Art Auction, which benefits the Center's art education programs. The silent auction will be held at the Community Center through February 12, from 9 AM to 5 PM daily. Final bids may be placed during the auction closing party on February 12 from 6 to 8 PM in Sonoma Community Center's Andrews Hall.

The birdhouses, both functional and sculptural, are the creations of Brad Bacon, Parker Bacon, Stacia Brady, Bonnie Brown, Hugh C. Byrne, Jim Callahan, Teddy Elston, Lucy Hamlyn, Susan

Heeringa-Pieper, Katherine Latour, Forrest Lesch-Mid-delton, Lin Lipetz, Jack Lundgren, Katie Morris, Beverly Prevost, Ann Selby, and Tom Winfree. Additionally, bird related artwork by Lin Lipetz, Bonnie Brown, and Christine Hansen will be available.

Stop by the Sonoma Community Center and place your bid between now and February 12. All bidders and potential bidders are invited to attend the auction closing party, which will include live music by Mobius Jazz Trio, as well as complimentary wine and snacks.

For more information, call 707.938.4626, extension 1, or visit [sonomacomcommunitycenter.org](http://sonomacomcommunitycenter.org). Sonoma Community Center is located at 276 East Napa Street in Sonoma.

## February is the Month for Romance

**F**ebruary has special meaning to most, with Valentine's Day as a way to celebrate hearts in love. Dimensions Galleria has the artful gift for that special someone, from art glass to ceramics, jewelry and more.

In celebration of love, Dimensions Galleria will be hosting "About Love," an evening of stories and characters that will take you through all the feelings of love -- the highs, the lows, and everything in between. Works will include

Edward Albee, e.e. cummings, Bob Krakower and more. The evening features local writers Caryl Fuller, Nancy Long, and Roger Marquis. This event will be held on February 5, 6, 19, and 20 at 8 PM. Tickets are \$12 and are available at Dimensions Galleria or online at [hazelstage.com/ReadersTheatre](http://hazelstage.com/ReadersTheatre). A portion of the proceeds will benefit Mentor Me Petaluma.

As part of Petaluma Art Walks on February 13, Dimensions Galleria will host local musician Javier Montiel with his guitar and original songs.

## Library Show Scheduled

**T**he Annual Library Show sponsored by the Petaluma Arts Association and the Friends of the Library will open on Friday, February 26 at 10 AM and close on Thursday, March 11 at 5 PM.

Works by local artists will include watercolors, oils, acrylics, photography, sculpture and more.

The reception for the artists will be held on Wednesday, March 9 from 6:30 to 8 PM. The reception will be co-hosted by the Petaluma Arts Association and the Friends of the Library.

The show location is the Helen Putnum Community Room at the Petaluma Regional Library, located at 100 Fairgrounds Drive in Petaluma. Show hours are Mondays, Thursdays, and Fridays from 10 AM to 5 PM; Tuesdays and Wednesdays from 10 AM to 8 PM; and Thursday, March 11, from 10 AM to 5 PM.

The Petaluma Arts Association has been promoting art appreciation in the Petaluma community for 51 years. Their scholarship program continues to support the Petaluma schools in developing student art programs.

Find out more about the Petaluma Arts Association programs at their website, [petalumaarts.org](http://petalumaarts.org), or write to P.O. Box 2623, Petaluma, CA 94953. Contact Tracy Bigelow Grisman for specific information about participating in the Library Show by calling 415.225.3018.

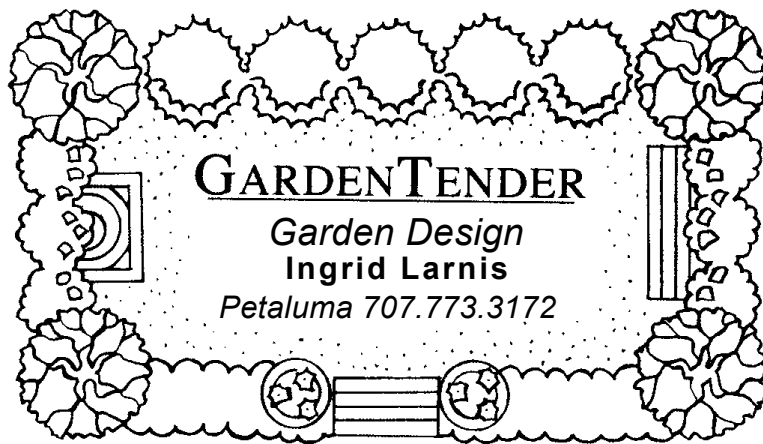

[www.GardenTender2000.com](http://www.GardenTender2000.com)

*Come Home to*  
**VALLEY ORCHARDS...**



**Active Retirement Living**  
*in* **Beautiful Sonoma County**

Monthly Rates as Low as **\$1,495** Including All Meals and Services (new residents only)

Call Today!  
**(707) 778-6030**

2100 East Washington St.  
Petaluma, CA 94954

[www.ValleyOrchards.com](http://www.ValleyOrchards.com)  
Visit our Napa Valley Community - [www.SilveradoOrchards.com](http://www.SilveradoOrchards.com)



*Locally Owned & Family Operated Since 1983*

**A FULL SERVICE RETIREMENT COMMUNITY**

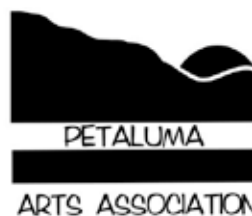

Supporting Local Artists and Grants for Local Schools Since 1957

[www.petalumaarts.org](http://www.petalumaarts.org)

Monthly Meetings ♦ Monthly Art Programs  
**707-793-2113**

Exhibit in Various Annual Venues, Including Petaluma's *Art in the Park*

Helping promote Petaluma as a regional arts destination in the Bay Area  
707.776.2788/[petalumapost@aol.com](mailto:petalumapost@aol.com)